

**EXPLANATION**

- Qal RECENT ALLUVIAL DEPOSITS
- Qlg BASIN-FILL DEPOSITS
- Tpg FORMATION OF TINAJA PEAK: Tpt = TUFFACEOUS CONGLOMERATE; Tpg = GRAVEL
- T TERTIARY INTRUSIVES, INCLUDES RUBY STAR INTRUSIVE, QUARTZ MONZONITE PORPHYRY, AND QUARTZ DIORITE PORPHYRY.
- Kd DEMETRIE VOLCANICS, ANDESITE AND DACITE BRECCIAS AND FLOWS.
- Kc ANGELICA ARKOSE
- Kf OX FRAME VOLCANICS, RHYOLITE FLOWS, TUFS, AND TUFF BRECCIAS WITH INTERCALATED LENTICULAR BEDS OF SANDSTONE/QUARTZITE AND ANDESITE/DACITE FLOWS.
- W-21 ● INTERCEPTOR WELL AND IDENTIFIER
- MH-12 ○ MONITOR WELL AND IDENTIFIER
- PZ-4 ▲ PIEZOMETER AND IDENTIFIER
- MH-14 □ PROPOSED POINT OF COMPLIANCE MONITOR WELL FOR HAZARDOUS CONSTITUENTS
- TL-4 □ PROPOSED POINT OF COMPLIANCE FOR NONHAZARDOUS CONSTITUENTS
- DP-1 ▼ WELL DRIVE POINT AND IDENTIFIER
- FAULT, SHOWING DIP; DASHED WHERE INFERRED, DOTTED WHERE CONCEALED
- CONTACT, SHOWING DIP
- STRIKE AND DIP OF BEDS
- PROPERTY BOUNDARY - CYPRUS SIERRITA CORPORATION
- SECTION CORNER
- LINE OF HYDROGEOLOGIC SECTION

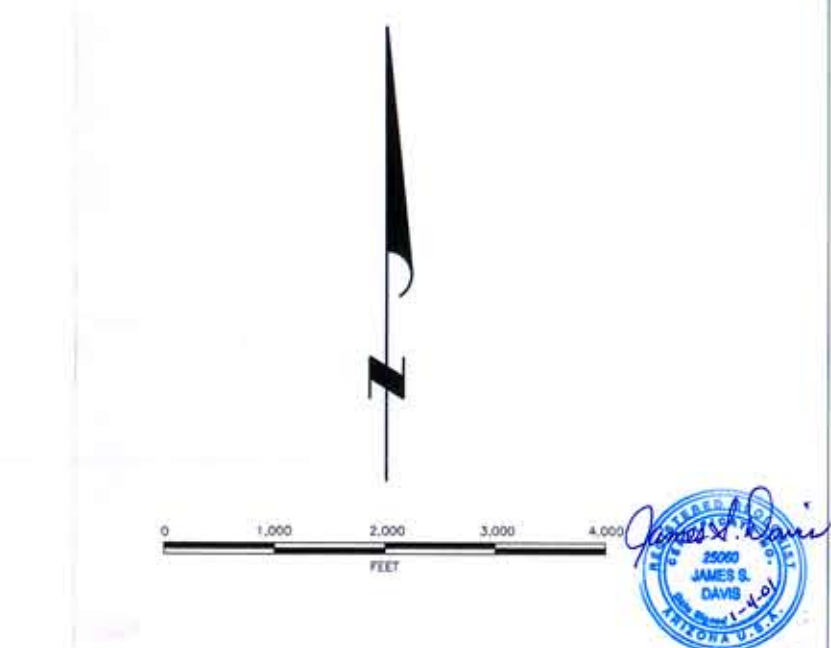

**PHELPS DODGE SIERRITA, INC.**  
 PIMA COUNTY, ARIZONA  
**HYDROGEOLOGIC FEATURES**  
**EAST HALF**  
**SIERRITA MINE**  
 ERROL L. MONTGOMERY & ASSOCIATES, INC. 2000  
 CONSULTANTS IN HYDROGEOLOGY  
 TUCSON, ARIZONA  
 FIGURE 4

Geology modified from Cooper (1973) and Phelps Dodge Sierrita, Inc.